



e-ISSN: 2319-8753 | p-ISSN: 2347-6710

# IJIRSET

International Journal of Innovative Research in  
**SCIENCE | ENGINEERING | TECHNOLOGY**



# INTERNATIONAL JOURNAL OF INNOVATIVE RESEARCH

IN SCIENCE | ENGINEERING | TECHNOLOGY

Volume 11, Issue 5, May 2022

**ISSN** INTERNATIONAL  
STANDARD  
SERIAL  
NUMBER  
INDIA

Impact Factor: 8.118

# Design and Fabrication of Dual Side Shaping Machine

**P. Anand KUMAR, S. Bhanu Teja, K. Mahima Raju, T. Pavan Kalyan Reddy, S. Srujan Kumar, M. Peddi Reddy, S. Thirumalesh,**

Assistant Professor, Department of Mechanical Engineering, Gates Institute of Technology Gooty,

Andhra Pradesh, India.

UG Students, Department of Mechanical Engineering, Gates Institute of Technology Gooty, Andhra Pradesh, India.

**ABSTRACT:** A large portion of the businesses are having different kinds of responding machines for performing machine procedure on little size of work. A molding machine is principally utilized for forming the devices, which might be flat, vertical or slanted. It is one of the primary parts in the enterprises. For the most part, we are utilizing single slider molding machine in the standard reason in enterprises. In this the time utilization is something else for machining the part and it consumes more power. In this task, a double side shaper machine is planned with the assistance of fast return component, the rotating movement of the engine is changed over into direct movement of the device which shapes the material mounted on the bad habit from both the side. The speedy return instrument changes over rotating movement into responding movement, however in contrast to the wrench and slider, the forward responding movement is at more slow rate than the bring stroke back. DC engine is associated with the component with the assistance of chain and sprocket. Entire instrument is based on rough metal edge. In this way, we will go to the double side shaper machine. In a double shaper machine, materials are formed from the two sides, which makes it more favorable than expected shaper. Double Shaper machine assists businesses with accomplishing high creation rate at a negligible measure of time and cost. Double Shaper machine diminishes the creation cost as well as the time.

**KEYWORDS:** shaper, dual side shaper, machining Centre.

## I. INTRODUCTION

A shaper Machine is a responding kind of machine that is utilized for delivering even, vertical level surfaces. The workpiece is fixed on the table and the Ram holds the single point cutting device. During sending stroke, (the single point devices joined to the slam and workpiece is fixed on a table). A molding machine is utilized to machine surfaces. It can cut bends, points and numerous different shapes. It is a famous machine in a studio on the grounds that its development is exceptionally straightforward despite the fact that it can create an assortment of work. The apparatus feed handle can be gone to gradually take care of the cutting device into the material as the 'slam' moves advances and in reverse. The solid machine bad habit holds the material safely. A little bad habit wouldn't be reasonable as the work could undoubtedly be pulled out of position and be harmed. The bad habit lays on a steel table which can be changed so it ca be gone all over and afterward secured ready. Pulling back on the grasp handle begins the 'smash' moving advances and in reverse.

The framing machine known as shaper machine furthermore is maybe the most capable machine used in progress and backing in gadget rooms. It is incredibly productive machine close with handling endlessly machine. The fundamental basic of framing machine-shaper machine is to cut surfaces that are at different capricious shapes. The framing machine - shaper machine contains electric motor that runs the rotational development. This development is changed to answering turn of events. The answering feed is ought to be related with the slicing gadget so much that the shaper pushes ahead and in switch. The outlining machine known as shaper machine besides is perhaps the most proficient machine utilized underway and moving in device rooms. It is incredibly gainful machine close with taking care of endlessly machine. The essential urgent of outlining machine-shaper machine is to cut surfaces that are at various uncommon shapes. The outlining machine - shaper machine includes electric engine that runs the rotational turn of events. This improvement is changed to responding progression. The responding feed is should be connected with the cutting device such a lot of that the shaper pushes ahead and thus around. During the regressive stroke, the upward situation of the shaper changes so it takes out some material during next cycle. The upward feed and cutting rate are changed according to match the kind of metal, meaning of cut and sort of development.

## II. LECTURER'S REVIEW

**R M Lathe et.al**, Scrutinized that normal machining process gobbles up high moment and grows the work cost, to beat these issues and difficulties he used robotized electric compacted air contraptions and PLCs in the forming machine. He made electro pneumatic circuit for performing shaping undertakings, which makes the movement self-loader by using a single point cutting gadget. Robotization of the machines are made with the help of pneumatic device, sensors, mechatronics and PLCs, etc.

**M.V.N Srujan Manohar et al**, concentrated on that pneumatic shaper is used for high making of customized gear cutting with auto requesting work piece. A little wrench gear structure has been in this manner thought up to show the device cutting associations in embellishment machines. Anand Shukla et al., Investigated that improving of the diminishing power and power usage of the fashioner machine by moving different boundaries during cutting movement using PC interface. He developed a strategy to find cutting power and power expected by the gadget to perform shaping system on work piece.

**Dharwa** , examined that imperativeness is the most basic perspective in the improvement of current imaginative human progression. The ordinary imperativeness sources are active sparse, so elective essentialness sources are found which should be unassuming, successfully available and should satisfy the specific necessities. Force expected for speeding up is well under the restriction of a typical strong person.

**R. Maguteeswaran et al**, analyzed that the different machining process in gathering organizations are finished by free machining machine. It needs more space for need and time with significant expenses. However, the making of multi action machine, which remembers three errands for a singular machine. The exercises are specifically entering, opening and framing Devanand

**R. Tayade et al**, examined that evaluation of cutting and balanced boundary addresses one of the main parts for quality and benefit which expect enormous work in the current collecting market. From clients see point quality is critical in light of the fact that the level of nature of the got thing (or thing) influences the degree of full fillment of the buyers during use of the gained items.

### Basic Functioning

In this machine, it has both the bearing of slam development and it eliminates a material from two work pieces at the same time. In this way, the machining time will be diminished and the creation rate will be expanded. conelike shape when pivoted about the middle hub of the isosceles triangle. Shaper Machine is utilized to eliminate the material from the outer layer of the workpiece by the use of responding single-point cutting instruments essentially on flat, vertical, and Inclined surfaces. The workpiece is fixed in the machine bad habit though the apparatus responds on the workpiece through smash. Molding machine is a machine intended for giving wanted shapes to the surfaces that might be level, vertical and level. A molding device is utilized to cut in bends, various points, and numerous different shapes.

### Project Description

The shaper machine is utilized to eliminate metal chips from a fast steel clear to accomplish a characterized structure. The metal in the clear will be eliminated exclusively in the forward stroke of an ordinary shaper machine, while the chips won't be taken out in the retrogressive stroke. The chips will be eliminated from the double side shaper machine during both forward and in reverse strokes. Individual machines are utilized in ventures to perform forming and crushing cycles.

To represent the double side machining time decrease in molding machines, a small Scotch burden component was fabricated. During the return movement of this forming machine, there is an inactive stroke. The inactive stroke is utilized as a cutting stroke in this venture, which upgrades the result rate. This might be achieved by incorporating a clapper box with a device, to such an extent that the plan on instrument and the game plan on device holder both have one device secured on the clapper box. To get the forward and return strokes, the engine wellspring of force with switch extras is used to work the smash on the aide plate. The machining season of a work thing is sliced down the

middle thanks to this game plan. This gadget takes into account molding procedure on the two sides of the shaper machine. Materials are treated on the two finishes in a double side shaper machine, making it more useful than a conventional shaper. These days, enterprises make progress toward a high result rate with minimal measure of time, cash, and exertion. The utilization of a double side shaper machine eliminates most of the disadvantages related with a solitary side shaper. The significant advantage of a double side shaper is that it decreases both time and assembling costs.

### III. METHODOLOGY

A double side shaper machine is made in this task with the assistance of a fast bring system back. The engine's turning activity is changed into direct movement, which shapes the material appended to the two finishes. The quick return instrument changes over responding energy into pivoting movement.

- Visit businesses.
- Assess current application.
- Assortment of Data.
- Planning.
- Assortment of unrefined substance.
- Creation work.
- Make a proto sort model.
- Accommodation of undertaking.

#### Design And Fabrication

The model is designed with the help of Creo software and the designed models in different views can be seen in Fig 1 and Fig 2.

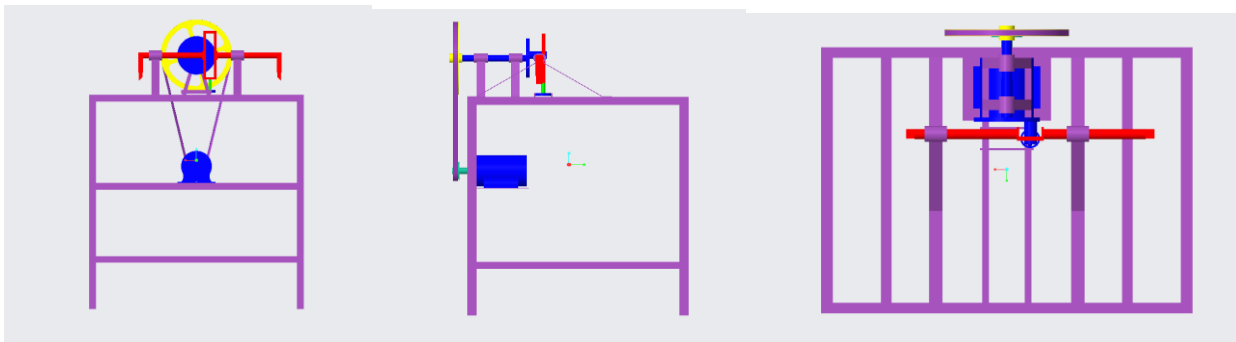

Fig 1: Front, Top and Side Views of the Designed Model

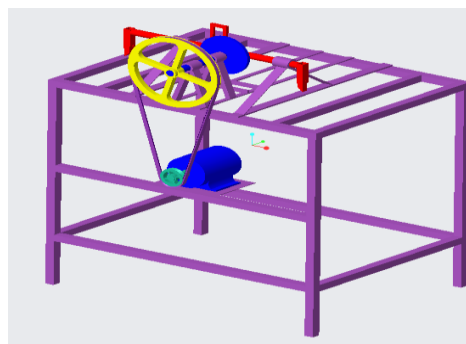

Fig 3: Isometric view of the dual side shaping machine.





**Frame:**

The parts are mounted on the edge, which is comprised of Mild steel. The portion of the parts are gathered on the edge by utilizing Arc welding The Components Used for creation are recorded in Table 1.

**Components**

Table 1: Components for Fabrication

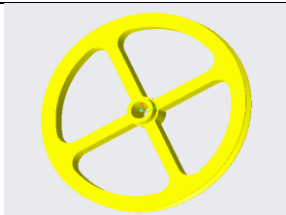
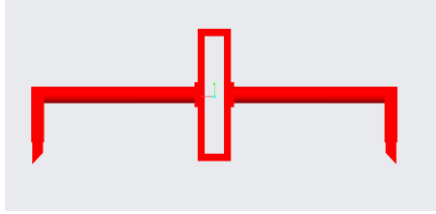
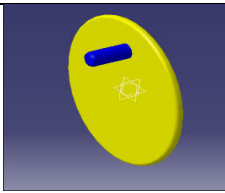
S.No	Name of the components	Images
1	Motor	
2	Belt	
3	Pulley	
4	Reciprocating rod	
5	Yoke	

**Parts To Be Explanation**

**1. Dc Motor:**



Fig 4: Dc Motor

The DC Motor is utilized to drive the entire component in the shaper machine. The DC Motor driven by the Direct Current. The DC engine deals with the standard of passing an ongoing in a guide inside an attractive field. A power is created on the guide. At the point when a gathering of these guides are fixed on a pivoting armature, a resultant force is created from every one of the powers on the singular guides. Most power supplies are AC (aside from unique applications, where the inventory is DC, e.g., rail routes). Hence, to work a DC engine, the AC supply must be redressed (and conceivably controlled) to give the vital DC voltage to take care of the engine.

## 2. Belt



Fig 5: Belt

V-belts will be belts with a trapezoidal cross-segment. Like different kinds of belts, they are utilized to send power or force from the driving part to the determined part. Their plan works with grasping onto the roller parts (i.e., pulleys) during activity, diminishing the gamble of slippage and expanding the consistency of the framework's result. The natural and working circumstances to which the V-belt will be oppressed fundamentally impact what type would be great. A portion of the variables to consider incorporate working velocities, irregular or persistent activity, misalignment resistance, format (e.g., serpentine or quarter turn), sent power, belt effectiveness, and openness to unforgiving circumstances (e.g., outrageous temperatures, abrasives, ozone, and oils). Contingent upon what elements are basic, industry experts might browse a wide scope of light-obligation or rock solid, modern V-belts.

## 3. Pulley

A pulley is a wheel on a hub or shaft that is intended to help development and divert pressure. They are basic, yet strong gadgets that can make little powers move enormous items. Pulleys are utilized to make weighty work more reasonable. The pullies are utilized to move the movement starting with one spot then onto the next place where the power is expected with the assistance of level/v-belts.



Fig 6: Pulley

## 4. Reciprocating Rod (Ram):

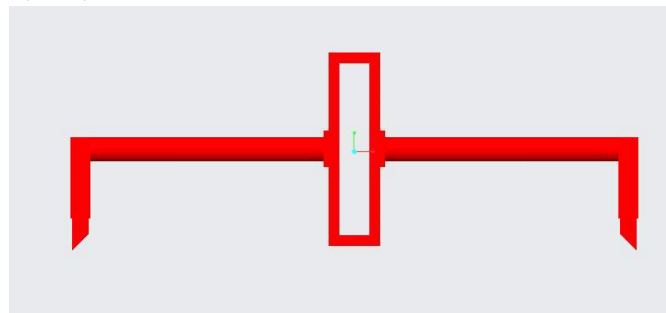

Fig 7: Reciprocating Rod (Ram)

The responding Circular bar is comprised of gentle steel. A little rectangular casing is comprised of little square pole by the welding system and it is joined to the two finishes of the roundabout bar as displayed in the figure. The two apparatus holders are joined to one more two finishes of the roundabout bar for upholding the cutting device in it.

## 5. Yoke

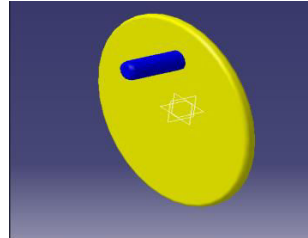

Fig 8: Yoke

The Scotch Yoke (otherwise called opened interface instrument) is a responding movement system, changing over the direct movement of a slider into rotational movement, or the other way around. The cylinder or other responding part is straightforwardly coupled to a sliding burden with an opening that draws in a pin on the turning part. The Yoke is a round circle which is mounted to the pulley. The burden pivots as base on the revolution of the pulley.

### Design Dimensions

- Width of the frame = 610mm
- Length of the frame = 810mm
- Height of the frame = 810mm
- Height of the lower arm = 180mm
- Height of the motor arm = 465mm
- Size of the frame bar = 25.4mm
- Thickness of the square bar sheet = 2mm
- Major diameter of pulley = 280mm
- Minor diameter of the pulley = 36mm
- Thickness of the pulley = 16mm
- Diameter of rod = 24mm
- Diameter of Yoke = 140mm
- Length of the ram = 500mm

### Layout of the Machine and Mechanism

The components (or) parts are assembled and the machining process is carried out. The fabrication of dual side shaper machine is clearly shown in figure

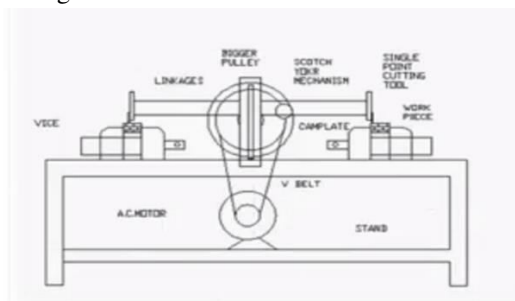

Fig 9: Layout the machine

### Working Procedure

Shaper is the metal cutting machine device intended for cutting level work piece by an instrument. Forming is utilized to machine meager and delicate plates. The activity of machine is streamlined to not many straightforward tasks including an engine and instrument head plan. At the point when the wrench is driven by an engine or by handle, the wrench turns about the pivot, so the crankpin slides inside the space of the opened plate. As the wrench turns, the

opened bar responds because of the sliding of wrench pin. The interfacing pole connected with the opened plate on the two sides, responds as the wrench pivots. The cutting instrument is joined at the two sides of interfacing bar, to complete the cutting activity. Since the cutting apparatus is put on the two sides, activity should be possible at both the sides of the machine.

The mechanism used in the double shaper is explained below.

#### Scotch Yoke Mechanism:

The Scotch burden (otherwise called opened interface component) is a responding movement instrument, changing over the straight movement of a slider into rotational movement or the other way around. The cylinder or other responding part is straightforwardly coupled to a sliding burden with a space that draws in a pin on the turning part. The area of the cylinder versus time is a sine wave of consistent sufficiency, and steady recurrence given a consistent rotational speed. This system is by and large found on forming machines where single point cutting device is mounted on the facade of the slider or smash, in a pivoted instrument post. The apparatus cuts on the delayed forward stroke and lifts over the work piece on the fast-bring stroke back.

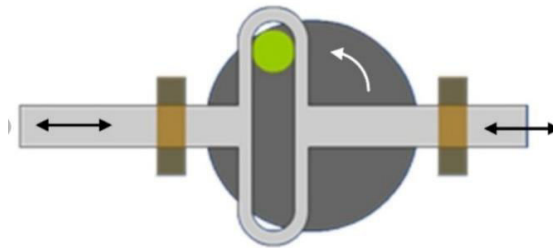

Fig 10: Scotch Yoke Mechanism

The scotch burden instrument (otherwise called opened connect system) is a responding movement component, changing over the direct movement of a slider into rotational movement, or the other way around. The responding part is straightforwardly coupled to a sliding burden with an opening that draws in a pin on the pivoting part.



Fig 11: fabrication of dual side shaping machine

#### Pros and cons Of Dual Side Shaping Machine:

- Low tooling cost., Easy to utilize. Consume less time when contrasted with a solitary side shaper machine. Expanding efficiency. Cost of creation diminishes.
- It is just appropriate for low and moderate levels. Not reasonable for weighty businesses.

#### Applications

- To create straight and level surfaces. To smooth unpleasant surfaces. To make inward splines. To make gear teeth. To make dovetail slides. To make keyways in pulleys or cog wheels.





#### **IV. CONCLUSION**

This double side shaper machine is utilized to produce parts like a standard shaper machine. Notwithstanding, the machining time expected for this double shaper is less when contrasted with the typical shaper. Consequently, the creation rate is expanded in the double side shaper machine when contrasted with the ordinary shaper. The machine consumes less space and less time when contrasted with the typical shaper. The planned double shaper has been utilized for just preliminary creation. Later on it would be utilized for business creation in enterprises

#### **REFERENCES**

- [1] Hnatovsky, C., Shvedov, V. G., Shostka, N., Rode, A. V., & Krolikowski, W. (2012). Polarizationdependent ablation of silicon using tightly focused femtosecond laser vortex pulses. *Optics Letters*, 37(2), 226-228.
- [2] D.M. Karnakis, J. Fieret, P.T. Rumsby, M.C. Gower, shaping using reshaped pulsed Gaussian laser beams, in: *Proceedings of SPIE*, vol. 4443, 2001.
- [3] "Cigar bunch shaper mechanism." U.S. Patent 2,102,298, issued December 14, 1937.
- [4] Safdar, S., Li, L., Sheikh, M. A., & Liu, Z. (2007). Finite element simulation of laser tube bending: Effect of scanning schemes on bending angle, distortions and stress distribution. *Optics & Laser Technology*, 39(6), 1101-1110.
- [5] SP Hotelling, BR Land (2011) 'DUAL SHAPER'- US patent 7,920,129.
- [6] KR Lessard, JM McElrath Jr (1983) 'DOUBLE SIDE RECIPROCATING SHAPER'-US Patent 4,383,401.



**INNO SPACE**  
SJIF Scientific Journal Impact Factor  
**Impact Factor: 8.118**



**ISSN** INTERNATIONAL  
STANDARD  
SERIAL  
NUMBER  
**INDIA**



# INTERNATIONAL JOURNAL OF INNOVATIVE RESEARCH

IN SCIENCE | ENGINEERING | TECHNOLOGY

 **9940 572 462**  **6381 907 438**  **ijirset@gmail.com**



**www.ijirset.com**

Scan to save the contact details